



## N200F

### Adjustable upper support

This mount is designed for long antennas where upper support is required. N200F does not become static when mounted around radiating elements of the antenna.

The mount can be mounted on any flat surface<sup>1</sup>.

N200F features a lever which can be opened for easy access to the antenna. E.g. if the antenna is to be lowered while parsing a bridge.

Bolts and two readymade spacers for the mount are included in the package.

<sup>1</sup> The surface may block/change the radiation pattern of the antenna.

#### Mechanical Specification:

Material	Polymer / PVC
Finish	White
Weight	0.70kg (1.54 lbs)
Mounting method	Deck and bulkhead mount, standoff
Radome diameter, Max	40mm

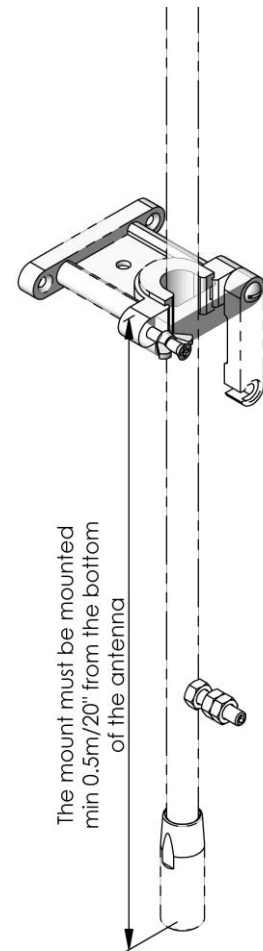

Apply extra filler (plastic/rubber) to fit the antenna tight to the mount when closed

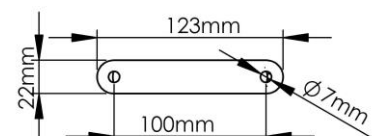
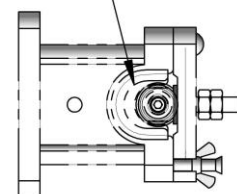

#### This part fits with:

No antenna included.

The requirement for upper support is specified on each antenna datasheet, such as: CX3, KUM601 and PD55-5.